

DATE: 3 May 2022
DESIGNER: Alex Naper
PROJECT No: SES 05322-2 Section 1 Rev B
PROJECT NAME: SHD Development Belcamp - Gerard Gannon Properties



Calculation Section 1: Grids 1 - 9, 13, 14, & 15.

Residential area designed in accordance with EN13201-2:2015 Category P4.

Link road designed in accordance with EN13201-2:2015 Category P2.

All luminaires proposed are warm white 2700K.

Rev A: Updates layout.
Rev B: Revised layout

Outdoor Lighting Report

PREPARED BY: Sabre Electrical Services Ltd.
Unit 11,
Bellview Industrial Estate,
Tolka Valley Road,
Dublin 11
Phone Number: 01 8110875
Contact: Graham Sheehan
eMail: graham@sabrelighting.ie

Layout Report

General Data

Dimensions in Metres Angles in Degrees

Calculation Grids

| ID | Grid Name | X | Y | X' Length | Y' Length | X' Spacing | Y' Spacing |
|----|-----------|-----------|-----------|-----------|-----------|------------|------------|
| 1 | Grid 1 | 720405.84 | 741318.98 | 374.90 | 144.00 | 1.50 | 1.50 |
| 2 | Grid 2 | 720032.14 | 741403.01 | 374.90 | 117.00 | 1.50 | 1.50 |
| 3 | Grid 3 | 719768.61 | 741729.26 | 374.90 | 169.28 | 1.50 | 1.50 |
| 4 | Grid 4 | 719568.53 | 741760.88 | 297.40 | 76.10 | 1.19 | 0.98 |
| 5 | Grid 5 | 720149.05 | 741446.67 | 69.00 | 21.00 | 1.50 | 1.50 |
| 6 | Grid 6 | 720172.43 | 741215.96 | 57.00 | 187.00 | 1.50 | 1.50 |
| 7 | Grid 7 | 719955.65 | 741190.12 | 244.00 | 283.00 | 1.50 | 1.50 |
| 8 | Grid 8 | 719739.76 | 741170.36 | 216.00 | 344.00 | 1.50 | 1.50 |
| 9 | Grid 9 | 720195.95 | 741174.53 | 245.88 | 255.85 | 1.50 | 1.50 |
| 10 | Grid 10 | 720455.65 | 741295.33 | 341.74 | 356.00 | 170.87 | 178.00 |
| 11 | Grid 11 | 720115.89 | 741459.90 | 341.74 | 331.00 | 170.87 | 165.50 |
| 12 | Grid 12 | 719957.94 | 741480.11 | 159.00 | 331.00 | 79.50 | 165.50 |
| 13 | Grid 13 | 719900.52 | 741304.33 | 282.61 | 57.00 | 1.50 | 1.50 |
| 14 | Grid 14 | 719954.93 | 741234.97 | 141.00 | 18.00 | 1.50 | 1.50 |
| 15 | Grid 15 | 719845.55 | 741243.13 | 79.45 | 18.00 | 1.50 | 1.50 |

Luminaire



Luminaire A Data

| | |
|----------------------|--|
| Supplier | Urbis Schreder |
| Type | AXIA 2.1 5165 Integrated lenses Rear louvers 16 OSLON SQUARE |
| Lamp(s) | 16 OSLON SQUARE GIANT@300mA WW 727 230V 00-36-648 |
| LampFlux(klm)/Colour | 2.27 WW 2700K/70 |
| File Name | AXIA 2.1 5165 16 OSLON SQUARE GIANT 300mA WW 727 15.9W 434262 Integrated ... |
| Maintenance Factor | 0.84 |
| Imax70,80,90(cd/klm) | 1250.5, 121.8, 2.3 |
| No. in Project | 20 |

Luminaire E Data

| | |
|----------------------|------------------------------|
| Supplier | C U Phosco |
| Type | E950-28-R3P-727-C300-9W |
| Lamp(s) | 727N |
| Lamp Flux (klm) | 1.12 |
| File Name | E950-28-R3P-727-C0300-9W.ies |
| Maintenance Factor | 0.84 |
| Imax70,80,90(cd/klm) | 900.6, 60.7, 0.3 |
| No. in Project | 34 |

Luminaire G Data

| | |
|----------------------|-------------------------------|
| Supplier | C U Phosco |
| Type | E950-28-P4A-727-C350-10W |
| Lamp(s) | 727N |
| Lamp Flux (klm) | 1.33 |
| File Name | E950-28-P4A-727-C0350-10W.ies |
| Maintenance Factor | 0.84 |
| Imax70,80,90(cd/klm) | 659.3, 183.1, 0.3 |
| No. in Project | 1 |

Luminaire H Data

| | |
|----------------------|-------------------------------|
| Supplier | C U Phosco |
| Type | E950-28-A2A-727-C650-17W |
| Lamp(s) | 727N |
| Lamp Flux (klm) | 2.15 |
| File Name | E950-28-A2A-727-C0650-17W.ies |
| Maintenance Factor | 0.84 |
| Imax70,80,90(cd/klm) | 470.3, 22.7, 0.9 |
| No. in Project | 5 |

Luminaires

Luminaire I Data

| | |
|----------------------|----------------------------------|
| Supplier | C U Phosco |
| Type | E951-64-P4-G-727-W5-0700-62W |
| Lamp(s) | 727SS |
| Lamp Flux (klm) | 8.67 |
| File Name | E951-64-P4-G-727-W5-0700-62W.ies |
| Maintenance Factor | 0.84 |
| Imax70,80,90(cd/klm) | 492.6, 81.8, 0.0 |
| No. in Project | 80 |

Luminaire J Data

| | |
|----------------------|-------------------------------|
| Supplier | C U Phosco |
| Type | E950-28-P4A-727-C550-14W |
| Lamp(s) | 727N |
| Lamp Flux (klm) | 2.03 |
| File Name | E950-28-P4A-727-C0550-14W.ies |
| Maintenance Factor | 0.84 |
| Imax70,80,90(cd/klm) | 659.3, 183.1, 0.3 |
| No. in Project | 38 |

Luminaire K Data

| | |
|----------------------|------------------------------|
| Supplier | C U Phosco |
| Type | E950-28-R3P-727-C300-9W |
| Lamp(s) | 727N |
| Lamp Flux (klm) | 1.12 |
| File Name | E950-28-R3P-727-C0300-9W.ies |
| Maintenance Factor | 0.84 |
| Imax70,80,90(cd/klm) | 900.6, 60.7, 0.3 |
| No. in Project | 12 |

Luminaire L Data

| | |
|----------------------|-------------------------------|
| Supplier | C U Phosco |
| Type | E950-28-P4A-727-C350-10W |
| Lamp(s) | 727N |
| Lamp Flux (klm) | 1.33 |
| File Name | E950-28-P4A-727-C0350-10W.ies |
| Maintenance Factor | 0.84 |
| Imax70,80,90(cd/klm) | 659.3, 183.1, 0.3 |
| No. in Project | 34 |

Luminaire M Data

| | |
|----------------------|-------------------------------|
| Supplier | C U Phosco |
| Type | E950-28-F2A-727-C700-18W |
| Lamp(s) | 727N |
| Lamp Flux (klm) | 2.56 |
| File Name | E950-28-F2A-727-C0700-18W.ies |
| Maintenance Factor | 0.84 |
| Imax70,80,90(cd/klm) | 623.6, 113.9, 0.3 |
| No. in Project | 13 |

Luminaire N Data

| | |
|----------------------|--------------------------------|
| Supplier | C U Phosco |
| Type | E950-28-P4A-727-SA0675-29W |
| Lamp(s) | 727SA |
| Lamp Flux (klm) | 3.23 |
| File Name | E950-28-P4A-727-SA0675-29W.ies |
| Maintenance Factor | 0.84 |
| Imax70,80,90(cd/klm) | 551.4, 55.4, 4.1 |
| No. in Project | 10 |



Luminaire O Data

| | |
|----------------------|---|
| Supplier | Urbis Schreder |
| Type | AXIA 2.1 5165 Integrated lenses Rear louvers 16 OSOLON SQUARE |
| Lamp(s) | 16 OSOLON SQUARE GIANT@300mA WW 727 230V 00-36-648 |
| LampFlux(klm)/Colour | 2.27 WW 2700K/70 |
| File Name | AXIA 2.1 5165 16 OSOLON SQUARE GIANT 300mA WW 727 15.9W 434262 Integrated ... |
| Maintenance Factor | 0.84 |
| Imax70,80,90(cd/klm) | 1250.5, 121.8, 2.3 |
| No. in Project | 10 |

Luminaire P Data

| | |
|----------------------|-------------------------------|
| Supplier | C U Phosco |
| Type | E950-28-P4A-727-C350-10W |
| Lamp(s) | 727N |
| Lamp Flux (klm) | 1.33 |
| File Name | E950-28-P4A-727-C0350-10W.ies |
| Maintenance Factor | 0.84 |
| Imax70,80,90(cd/klm) | 659.3, 183.1, 0.3 |
| No. in Project | 1 |

Luminaires

Luminaire Q Data

| | |
|----------------------|-------------------------------|
| Supplier | C U Phosco |
| Type | E950-28-P4A-727-C550-14W |
| Lamp(s) | 727N |
| Lamp Flux (klm) | 2.03 |
| File Name | E950-28-P4A-727-C0550-14W.ies |
| Maintenance Factor | 0.84 |
| Imax70,80,90(cd/klm) | 659.3, 183.1, 0.3 |
| No. in Project | 15 |

Luminaire R Data

| | |
|----------------------|-------------------------------|
| Supplier | C U Phosco |
| Type | E950-28-F2A-727-C700-18W |
| Lamp(s) | 727N |
| Lamp Flux (klm) | 2.56 |
| File Name | E950-28-F2A-727-C0700-18W.ies |
| Maintenance Factor | 0.84 |
| Imax70,80,90(cd/klm) | 623.6, 113.9, 0.3 |
| No. in Project | 8 |

Layout

| ID | Type | X | Y | Height | Angle | Tilt | Cant | Out-reach | Dimmed to | Target X | Target Y | Target Z |
|----|------|-----------|-----------|--------|--------|------|------|-----------|-----------|----------|----------|----------|
| 1 | I | 720776.48 | 741334.15 | 10.00 | 95.00 | 5.00 | 0.00 | 0.40 | 100% | | | |
| 2 | I | 720783.25 | 741354.79 | 10.00 | 275.00 | 5.00 | 0.00 | 0.40 | 100% | | | |
| 3 | I | 720813.82 | 741338.28 | 10.00 | 91.00 | 5.00 | 0.00 | 0.40 | 100% | | | |
| 4 | I | 720737.06 | 741334.43 | 10.00 | 73.00 | 0.00 | 0.00 | 0.40 | 100% | | | |
| 5 | I | 720758.02 | 741350.97 | 10.00 | 265.00 | 0.00 | 0.00 | 0.40 | 100% | | | |
| 6 | I | 720720.72 | 741356.16 | 10.00 | 255.00 | 0.00 | 0.00 | 0.40 | 100% | | | |
| 7 | I | 720698.80 | 741345.87 | 10.00 | 73.00 | 0.00 | 0.00 | 0.40 | 100% | | | |
| 8 | I | 720685.24 | 741367.80 | 10.00 | 258.00 | 0.00 | 0.00 | 0.40 | 100% | | | |
| 9 | I | 720659.86 | 741354.72 | 10.00 | 86.00 | 0.00 | 0.00 | 0.40 | 100% | | | |
| 10 | I | 720642.45 | 741375.30 | 10.00 | 264.00 | 0.00 | 0.00 | 0.40 | 100% | | | |
| 11 | I | 720621.30 | 741358.85 | 10.00 | 85.00 | 0.00 | 0.00 | 0.40 | 100% | | | |
| 12 | I | 720581.59 | 741363.85 | 10.00 | 81.00 | 0.00 | 0.00 | 0.40 | 100% | | | |
| 13 | I | 720603.51 | 741378.37 | 10.00 | 265.00 | 0.00 | 0.00 | 0.40 | 100% | | | |
| 14 | I | 720567.65 | 741385.78 | 10.00 | 242.00 | 0.00 | 0.00 | 0.40 | 100% | | | |
| 15 | I | 720541.31 | 741377.51 | 10.00 | 62.00 | 0.00 | 0.00 | 0.40 | 100% | | | |
| 16 | I | 720516.50 | 741411.83 | 10.00 | 256.00 | 0.00 | 0.00 | 0.40 | 100% | | | |
| 17 | I | 720506.22 | 741396.74 | 10.00 | 58.00 | 0.00 | 0.00 | 0.40 | 100% | | | |
| 18 | I | 720495.54 | 741425.10 | 10.00 | 248.00 | 0.00 | 0.00 | 0.40 | 100% | | | |
| 19 | I | 720468.14 | 741420.29 | 10.00 | 72.00 | 0.00 | 0.00 | 0.40 | 100% | | | |
| 20 | I | 720452.37 | 741445.39 | 10.00 | 260.00 | 0.00 | 0.00 | 0.40 | 100% | | | |
| 21 | I | 720428.39 | 741430.28 | 10.00 | 92.00 | 0.00 | 0.00 | 0.40 | 100% | | | |
| 22 | I | 720408.23 | 741447.23 | 10.00 | 278.00 | 0.00 | 0.00 | 0.40 | 100% | | | |
| 23 | G | 720541.68 | 741367.37 | 5.00 | 337.00 | 0.00 | 0.00 | 0.40 | 100% | | | |
| 24 | I | 720390.93 | 741427.47 | 10.00 | 98.00 | 0.00 | 0.00 | 0.40 | 100% | | | |
| 25 | I | 720369.04 | 741443.98 | 10.00 | 272.00 | 0.00 | 0.00 | 0.40 | 100% | | | |
| 26 | I | 720350.62 | 741423.65 | 10.00 | 92.00 | 0.00 | 0.00 | 0.40 | 100% | | | |
| 27 | I | 720329.36 | 741439.83 | 10.00 | 272.00 | 0.00 | 0.00 | 0.40 | 100% | | | |
| 28 | I | 720310.03 | 741422.41 | 10.00 | 86.00 | 0.00 | 0.00 | 0.40 | 100% | | | |
| 29 | I | 720288.15 | 741442.02 | 10.00 | 262.00 | 0.00 | 0.00 | 0.40 | 100% | | | |
| 30 | I | 720267.42 | 741426.78 | 10.00 | 83.00 | 0.00 | 0.00 | 0.40 | 100% | | | |
| 31 | I | 720240.49 | 741449.90 | 10.00 | 261.00 | 0.00 | 0.00 | 0.40 | 100% | | | |
| 32 | I | 720228.61 | 741433.57 | 10.00 | 84.00 | 0.00 | 0.00 | 0.40 | 100% | | | |
| 33 | I | 720203.71 | 741458.92 | 10.00 | 254.00 | 0.00 | 0.00 | 0.40 | 100% | | | |
| 34 | I | 720177.38 | 741441.27 | 10.00 | 74.00 | 0.00 | 0.00 | 0.40 | 100% | | | |
| 35 | I | 720162.83 | 741468.04 | 10.00 | 260.00 | 0.00 | 0.00 | 0.40 | 100% | | | |
| 36 | I | 720138.26 | 741449.47 | 10.00 | 76.00 | 0.00 | 0.00 | 0.40 | 100% | | | |

Layout Continued

| ID | Type | X | Y | Height | Angle | Tilt | Cant | Out-reach | Dimmed to | Target X | Target Y | Target Z |
|----|------|-----------|-----------|--------|--------|------|------|-----------|-----------|----------|----------|----------|
| 37 | I | 720122.41 | 741474.34 | 10.00 | 261.00 | 0.00 | 0.00 | 0.40 | 100% | | | |
| 38 | I | 720084.19 | 741479.81 | 10.00 | 254.00 | 0.00 | 0.00 | 0.40 | 100% | | | |
| 39 | I | 720098.28 | 741457.90 | 10.00 | 73.00 | 0.00 | 0.00 | 0.40 | 100% | | | |
| 40 | I | 720055.29 | 741468.94 | 10.00 | 66.00 | 0.00 | 0.00 | 0.40 | 100% | | | |
| 41 | I | 720047.94 | 741491.90 | 10.00 | 239.00 | 0.00 | 0.00 | 0.40 | 100% | | | |
| 42 | I | 720013.75 | 741490.15 | 10.00 | 59.00 | 0.00 | 0.00 | 0.40 | 100% | | | |
| 43 | I | 720173.88 | 741430.27 | 10.00 | 350.00 | 0.00 | 0.00 | 0.40 | 100% | | | |
| 44 | I | 720194.27 | 741413.13 | 10.00 | 178.00 | 0.00 | 0.00 | 0.40 | 100% | | | |
| 45 | I | 720007.80 | 741517.79 | 10.00 | 232.00 | 0.00 | 0.00 | 0.40 | 100% | | | |
| 46 | I | 719973.41 | 741526.66 | 10.00 | 24.00 | 0.00 | 0.00 | 0.40 | 100% | | | |
| 47 | I | 719980.16 | 741548.00 | 10.00 | 210.00 | 0.00 | 0.00 | 0.40 | 100% | | | |
| 48 | Q | 720016.00 | 741546.03 | 6.00 | 264.00 | 0.00 | 0.00 | 0.40 | 100% | | | |
| 49 | I | 719953.42 | 741556.48 | 10.00 | 34.00 | 0.00 | 0.00 | 0.40 | 100% | | | |
| 50 | I | 719960.62 | 741582.96 | 10.00 | 205.00 | 0.00 | 0.00 | 0.40 | 100% | | | |
| 51 | I | 719937.40 | 741597.60 | 10.00 | 9.00 | 0.00 | 0.00 | 0.40 | 100% | | | |
| 52 | I | 719950.74 | 741620.15 | 10.00 | 189.00 | 0.00 | 0.00 | 0.40 | 100% | | | |
| 53 | I | 719930.79 | 741637.28 | 10.00 | 2.00 | 0.00 | 0.00 | 0.40 | 100% | | | |
| 54 | I | 719948.67 | 741656.97 | 10.00 | 173.00 | 0.00 | 0.00 | 0.40 | 100% | | | |
| 55 | I | 719932.56 | 741676.18 | 10.00 | 347.00 | 0.00 | 0.00 | 0.40 | 100% | | | |
| 56 | I | 719952.70 | 741695.28 | 10.00 | 177.00 | 0.00 | 0.00 | 0.40 | 100% | | | |
| 57 | I | 719934.52 | 741717.03 | 10.00 | 10.00 | 0.00 | 0.00 | 0.40 | 100% | | | |
| 58 | I | 719945.57 | 741743.03 | 10.00 | 205.00 | 0.00 | 0.00 | 0.40 | 100% | | | |
| 59 | I | 719920.11 | 741752.20 | 10.00 | 39.00 | 0.00 | 0.00 | 0.40 | 100% | | | |
| 60 | I | 719917.84 | 741780.54 | 10.00 | 229.00 | 0.00 | 0.00 | 0.40 | 100% | | | |
| 61 | I | 719891.95 | 741776.51 | 10.00 | 61.00 | 0.00 | 0.00 | 0.40 | 100% | | | |
| 62 | I | 719877.11 | 741801.02 | 10.00 | 250.00 | 0.00 | 0.00 | 0.40 | 100% | | | |
| 63 | I | 719852.53 | 741785.77 | 10.00 | 83.00 | 0.00 | 0.00 | 0.40 | 100% | | | |
| 64 | I | 719834.15 | 741804.20 | 10.00 | 260.00 | 0.00 | 0.00 | 0.40 | 100% | | | |
| 65 | I | 719812.00 | 741788.04 | 10.00 | 82.00 | 0.00 | 0.00 | 0.40 | 100% | | | |
| 66 | I | 719794.29 | 741807.04 | 10.00 | 262.00 | 0.00 | 0.00 | 0.40 | 100% | | | |
| 67 | I | 719771.32 | 741790.36 | 10.00 | 91.00 | 0.00 | 0.00 | 0.40 | 100% | | | |
| 68 | I | 719752.89 | 741809.21 | 10.00 | 266.00 | 0.00 | 0.00 | 0.40 | 100% | | | |
| 69 | I | 719730.79 | 741791.29 | 10.00 | 91.00 | 0.00 | 0.00 | 0.40 | 100% | | | |
| 70 | I | 719710.92 | 741808.64 | 10.00 | 272.00 | 0.00 | 0.00 | 0.40 | 100% | | | |
| 71 | I | 719692.85 | 741789.43 | 10.00 | 91.00 | 0.00 | 0.00 | 0.40 | 100% | | | |
| 72 | I | 719671.42 | 741805.49 | 10.00 | 276.00 | 0.00 | 0.00 | 0.40 | 100% | | | |

Layout Continued

| ID | Type | X | Y | Height | Angle | Tilt | Cant | Out-reach | Dimmed to | Target X | Target Y | Target Z |
|-----|------|-----------|-----------|--------|--------|------|------|-----------|-----------|----------|----------|----------|
| 73 | I | 719654.59 | 741785.20 | 10.00 | 96.00 | 0.00 | 0.00 | 0.40 | 100% | | | |
| 74 | I | 719633.86 | 741799.71 | 10.00 | 277.00 | 0.00 | 0.00 | 0.40 | 100% | | | |
| 76 | I | 720177.89 | 741393.54 | 10.00 | 9.00 | 0.00 | 0.00 | 0.40 | 100% | | | |
| 77 | I | 720200.45 | 741382.02 | 10.00 | 191.00 | 0.00 | 0.00 | 0.40 | 100% | | | |
| 78 | I | 720186.22 | 741358.52 | 10.00 | 23.00 | 0.00 | 0.00 | 0.40 | 100% | | | |
| 79 | I | 720209.72 | 741332.23 | 10.00 | 180.00 | 0.00 | 0.00 | 0.40 | 100% | | | |
| 80 | I | 720195.22 | 741308.24 | 10.00 | 358.00 | 0.00 | 0.00 | 0.40 | 100% | | | |
| 81 | I | 720212.58 | 741288.39 | 10.00 | 176.00 | 0.00 | 0.00 | 0.40 | 100% | | | |
| 82 | I | 720194.76 | 741264.69 | 10.00 | 347.00 | 0.00 | 0.00 | 0.40 | 100% | | | |
| 83 | I | 720211.00 | 741246.10 | 10.00 | 178.00 | 0.00 | 0.00 | 0.40 | 100% | | | |
| 84 | N | 720173.21 | 741346.35 | 6.00 | 88.00 | 0.00 | 0.00 | 0.40 | 100% | | | |
| 85 | K | 720208.94 | 741196.33 | 5.00 | 179.00 | 0.00 | 0.00 | 0.40 | 100% | | | |
| 86 | K | 720197.62 | 741196.92 | 5.00 | 179.00 | 0.00 | 0.00 | 0.40 | 100% | | | |
| 87 | K | 720197.75 | 741196.80 | 5.00 | 354.00 | 0.00 | 0.00 | 0.40 | 100% | | | |
| 88 | K | 720209.19 | 741196.37 | 5.00 | 354.00 | 0.00 | 0.00 | 0.40 | 100% | | | |
| 89 | E | 720198.05 | 741217.51 | 5.00 | 354.00 | 0.00 | 0.00 | 0.40 | 100% | | | |
| 90 | E | 720210.71 | 741218.05 | 5.00 | 354.00 | 0.00 | 0.00 | 0.40 | 100% | | | |
| 91 | E | 720197.67 | 741217.51 | 5.00 | 184.00 | 0.00 | 0.00 | 0.40 | 100% | | | |
| 92 | E | 720210.47 | 741217.96 | 5.00 | 179.00 | 0.00 | 0.00 | 0.40 | 100% | | | |
| 93 | J | 720175.82 | 741263.09 | 6.00 | 285.00 | 0.00 | 0.00 | 0.40 | 100% | | | |
| 94 | J | 720141.74 | 741256.97 | 6.00 | 283.00 | 0.00 | 0.00 | 0.40 | 100% | | | |
| 95 | E | 720177.18 | 741270.95 | 5.00 | 286.00 | 0.00 | 0.00 | 0.40 | 100% | | | |
| 96 | E | 720159.90 | 741275.93 | 5.00 | 186.00 | 0.00 | 0.00 | 0.40 | 100% | | | |
| 97 | L | 720119.92 | 741268.15 | 6.00 | 202.00 | 0.00 | 0.00 | 0.40 | 100% | | | |
| 98 | J | 720103.15 | 741248.83 | 6.00 | 283.00 | 0.00 | 0.00 | 0.40 | 100% | | | |
| 99 | J | 720067.51 | 741241.36 | 6.00 | 283.00 | 0.00 | 0.00 | 0.40 | 100% | | | |
| 100 | J | 720030.59 | 741233.49 | 6.00 | 286.00 | 0.00 | 0.00 | 0.40 | 100% | | | |
| 101 | J | 720003.57 | 741236.03 | 6.00 | 195.00 | 0.00 | 0.00 | 0.40 | 100% | | | |
| 102 | J | 719983.66 | 741223.35 | 6.00 | 283.00 | 0.00 | 0.00 | 0.40 | 100% | | | |
| 103 | J | 720005.08 | 741220.26 | 6.00 | 104.00 | 0.00 | 0.00 | 0.40 | 100% | | | |
| 104 | J | 719955.65 | 741217.77 | 6.00 | 283.00 | 0.00 | 0.00 | 0.40 | 100% | | | |
| 105 | J | 719999.25 | 741256.92 | 6.00 | 192.00 | 0.00 | 0.00 | 0.40 | 100% | | | |
| 106 | J | 719982.88 | 741265.40 | 6.00 | 283.00 | 0.00 | 0.00 | 0.40 | 100% | | | |
| 107 | J | 719956.01 | 741259.83 | 6.00 | 283.00 | 0.00 | 0.00 | 0.40 | 100% | | | |
| 108 | J | 720004.48 | 741269.89 | 6.00 | 283.00 | 0.00 | 0.00 | 0.40 | 100% | | | |
| 109 | J | 720038.69 | 741277.22 | 6.00 | 284.00 | 0.00 | 0.00 | 0.40 | 100% | | | |

Layout Continued

| ID | Type | X | Y | Height | Angle | Tilt | Cant | Out-reach | Dimmed to | Target X | Target Y | Target Z |
|-----|------|-----------|-----------|--------|--------|------|------|-----------|-----------|----------|----------|----------|
| 110 | L | 720054.93 | 741296.44 | 6.00 | 16.00 | 0.00 | 0.00 | 0.40 | 100% | | | |
| 111 | L | 720046.20 | 741329.99 | 6.00 | 7.00 | 0.00 | 0.00 | 0.40 | 100% | | | |
| 112 | J | 719991.46 | 741284.81 | 6.00 | 191.00 | 0.00 | 0.00 | 0.40 | 100% | | | |
| 113 | J | 719983.58 | 741312.15 | 6.00 | 205.00 | 0.00 | 0.00 | 0.40 | 100% | | | |
| 114 | J | 719976.54 | 741346.27 | 6.00 | 182.00 | 0.00 | 0.00 | 0.40 | 100% | | | |
| 115 | J | 719971.21 | 741380.53 | 6.00 | 195.00 | 0.00 | 0.00 | 0.40 | 100% | | | |
| 116 | J | 719973.99 | 741392.50 | 6.00 | 106.00 | 0.00 | 0.00 | 0.40 | 100% | | | |
| 117 | J | 720026.46 | 741403.59 | 6.00 | 104.00 | 0.00 | 0.00 | 0.40 | 100% | | | |
| 118 | J | 719947.96 | 741387.06 | 6.00 | 98.00 | 0.00 | 0.00 | 0.40 | 100% | | | |
| 119 | J | 720002.86 | 741398.54 | 6.00 | 105.00 | 0.00 | 0.00 | 0.40 | 100% | | | |
| 120 | L | 720040.12 | 741362.20 | 6.00 | 13.00 | 0.00 | 0.00 | 0.40 | 100% | | | |
| 121 | L | 720034.36 | 741389.47 | 6.00 | 11.00 | 0.00 | 0.00 | 0.40 | 100% | | | |
| 122 | E | 720067.12 | 741276.23 | 5.00 | 122.00 | 0.00 | 0.00 | 0.40 | 100% | | | |
| 123 | E | 720082.62 | 741283.44 | 5.00 | 103.00 | 0.00 | 0.00 | 0.40 | 100% | | | |
| 124 | L | 720034.62 | 741418.41 | 6.00 | 193.00 | 0.00 | 0.00 | 0.40 | 100% | | | |
| 125 | L | 720030.36 | 741467.50 | 6.00 | 147.00 | 0.00 | 0.00 | 0.40 | 100% | | | |
| 126 | L | 720028.60 | 741442.95 | 6.00 | 197.00 | 0.00 | 0.00 | 0.40 | 100% | | | |
| 127 | L | 720106.28 | 741301.25 | 6.00 | 208.00 | 0.00 | 0.00 | 0.40 | 100% | | | |
| 128 | L | 720094.41 | 741328.23 | 6.00 | 201.00 | 0.00 | 0.00 | 0.40 | 100% | | | |
| 129 | L | 720127.89 | 741277.74 | 6.00 | 117.00 | 0.00 | 0.00 | 0.40 | 100% | | | |
| 130 | L | 720152.27 | 741284.24 | 6.00 | 117.00 | 0.00 | 0.00 | 0.40 | 100% | | | |
| 131 | L | 720143.29 | 741306.92 | 6.00 | 20.00 | 0.00 | 0.00 | 0.40 | 100% | | | |
| 132 | L | 720157.45 | 741307.79 | 6.00 | 202.00 | 0.00 | 0.00 | 0.40 | 100% | | | |
| 133 | L | 720145.67 | 741329.06 | 6.00 | 300.00 | 0.00 | 0.00 | 0.40 | 100% | | | |
| 134 | L | 720153.51 | 741344.73 | 6.00 | 186.00 | 0.00 | 0.00 | 0.40 | 100% | | | |
| 135 | M | 720166.05 | 741329.70 | 6.00 | 91.00 | 0.00 | 0.00 | 0.40 | 100% | | | |
| 136 | L | 720069.89 | 741364.72 | 6.00 | 191.00 | 0.00 | 0.00 | 0.40 | 100% | | | |
| 137 | L | 720062.46 | 741399.18 | 6.00 | 201.00 | 0.00 | 0.00 | 0.40 | 100% | | | |
| 138 | L | 720055.20 | 741429.89 | 6.00 | 191.00 | 0.00 | 0.00 | 0.40 | 100% | | | |
| 139 | L | 720070.13 | 741407.45 | 6.00 | 93.00 | 0.00 | 0.00 | 0.40 | 100% | | | |
| 140 | L | 720104.08 | 741414.05 | 6.00 | 103.00 | 0.00 | 0.00 | 0.40 | 100% | | | |
| 141 | L | 720101.26 | 741426.24 | 6.00 | 199.00 | 0.00 | 0.00 | 0.40 | 100% | | | |
| 142 | L | 720084.62 | 741425.32 | 6.00 | 15.00 | 0.00 | 0.00 | 0.40 | 100% | | | |
| 143 | L | 720129.08 | 741415.02 | 6.00 | 98.00 | 0.00 | 0.00 | 0.40 | 100% | | | |
| 144 | L | 720154.04 | 741423.05 | 6.00 | 184.00 | 0.00 | 0.00 | 0.40 | 100% | | | |
| 145 | L | 720153.85 | 741394.57 | 6.00 | 15.00 | 0.00 | 0.00 | 0.40 | 100% | | | |

Layout Continued

| ID | Type | X | Y | Height | Angle | Tilt | Cant | Out-reach | Dimmed to | Target X | Target Y | Target Z |
|-----|------|-----------|-----------|--------|--------|------|------|-----------|-----------|----------|----------|----------|
| 146 | L | 720158.56 | 741366.24 | 6.00 | 3.00 | 0.00 | 0.00 | 0.40 | 100% | | | |
| 147 | E | 720120.82 | 741431.06 | 5.00 | 263.00 | 0.00 | 0.00 | 0.40 | 100% | | | |
| 148 | E | 720091.06 | 741437.13 | 5.00 | 252.00 | 0.00 | 0.00 | 0.40 | 100% | | | |
| 149 | E | 720080.87 | 741448.31 | 5.00 | 168.00 | 0.00 | 0.00 | 0.40 | 100% | | | |
| 150 | E | 720065.13 | 741441.85 | 5.00 | 102.00 | 0.00 | 0.00 | 0.40 | 100% | | | |
| 151 | E | 720053.39 | 741452.40 | 5.00 | 263.00 | 0.00 | 0.00 | 0.40 | 100% | | | |
| 152 | E | 720043.35 | 741429.23 | 5.00 | 10.00 | 0.00 | 0.00 | 0.40 | 100% | | | |
| 153 | E | 720052.58 | 741389.73 | 5.00 | 9.00 | 0.00 | 0.00 | 0.40 | 100% | | | |
| 154 | E | 720053.74 | 741358.08 | 5.00 | 338.00 | 0.00 | 0.00 | 0.40 | 100% | | | |
| 155 | E | 720052.39 | 741370.88 | 5.00 | 49.00 | 0.00 | 0.00 | 0.40 | 100% | | | |
| 156 | N | 720085.22 | 741353.21 | 6.00 | 273.00 | 0.00 | 0.00 | 0.40 | 100% | | | |
| 157 | E | 720105.67 | 741263.05 | 5.00 | 190.00 | 0.00 | 0.00 | 0.40 | 100% | | | |
| 158 | E | 720102.06 | 741278.75 | 5.00 | 297.00 | 0.00 | 0.00 | 0.40 | 100% | | | |
| 159 | E | 720090.17 | 741291.27 | 5.00 | 197.00 | 0.00 | 0.00 | 0.40 | 100% | | | |
| 160 | E | 720078.23 | 741312.20 | 5.00 | 186.00 | 0.00 | 0.00 | 0.40 | 100% | | | |
| 161 | E | 720069.40 | 741327.98 | 5.00 | 243.00 | 0.00 | 0.00 | 0.40 | 100% | | | |
| 162 | E | 720063.14 | 741337.60 | 5.00 | 192.00 | 0.00 | 0.00 | 0.40 | 100% | | | |
| 163 | E | 720086.44 | 741316.67 | 5.00 | 115.00 | 0.00 | 0.00 | 0.40 | 100% | | | |
| 164 | E | 720042.48 | 741463.87 | 5.00 | 216.00 | 0.00 | 0.00 | 0.40 | 100% | | | |
| 165 | J | 719944.52 | 741234.50 | 6.00 | 192.00 | 0.00 | 0.00 | 0.40 | 100% | | | |
| 166 | J | 719927.32 | 741254.06 | 6.00 | 271.00 | 0.00 | 0.00 | 0.40 | 100% | | | |
| 167 | J | 719892.85 | 741259.79 | 6.00 | 259.00 | 0.00 | 0.00 | 0.40 | 100% | | | |
| 168 | J | 719873.83 | 741279.50 | 6.00 | 170.00 | 0.00 | 0.00 | 0.40 | 100% | | | |
| 169 | J | 719891.91 | 741302.69 | 6.00 | 145.00 | 0.00 | 0.00 | 0.40 | 100% | | | |
| 170 | N | 719898.31 | 741333.13 | 6.00 | 243.00 | 0.00 | 0.00 | 0.40 | 100% | | | |
| 171 | N | 719925.44 | 741323.35 | 6.00 | 263.00 | 0.00 | 0.00 | 0.40 | 100% | | | |
| 172 | J | 719875.45 | 741340.53 | 6.00 | 250.00 | 0.00 | 0.00 | 0.40 | 100% | | | |
| 173 | J | 719880.51 | 741363.48 | 6.00 | 159.00 | 0.00 | 0.00 | 0.40 | 100% | | | |
| 174 | J | 719890.65 | 741390.34 | 6.00 | 153.00 | 0.00 | 0.00 | 0.40 | 100% | | | |
| 175 | J | 719914.37 | 741390.03 | 6.00 | 69.00 | 0.00 | 0.00 | 0.40 | 100% | | | |
| 176 | N | 720141.71 | 741347.28 | 6.00 | 93.00 | 0.00 | 0.00 | 0.40 | 100% | | | |
| 177 | N | 720113.84 | 741345.80 | 6.00 | 91.00 | 0.00 | 0.00 | 0.40 | 100% | | | |
| 178 | N | 720058.01 | 741350.33 | 6.00 | 279.00 | 0.00 | 0.00 | 0.40 | 100% | | | |
| 179 | N | 720021.70 | 741342.64 | 6.00 | 281.00 | 0.00 | 0.00 | 0.40 | 100% | | | |
| 180 | N | 719989.02 | 741335.57 | 6.00 | 280.00 | 0.00 | 0.00 | 0.40 | 100% | | | |
| 181 | N | 719954.07 | 741328.38 | 6.00 | 283.00 | 0.00 | 0.00 | 0.40 | 100% | | | |

Layout Continued

| ID | Type | X | Y | Height | Angle | Tilt | Cant | Out-reach | Dimmed to | Target X | Target Y | Target Z |
|-----|------|-----------|-----------|--------|--------|------|------|-----------|-----------|----------|----------|----------|
| 182 | M | 719965.21 | 741251.72 | 6.00 | 277.00 | 0.00 | 0.00 | 0.40 | 100% | | | |
| 183 | M | 719982.45 | 741255.29 | 6.00 | 279.00 | 0.00 | 0.00 | 0.40 | 100% | | | |
| 184 | M | 720018.82 | 741262.80 | 6.00 | 279.00 | 0.00 | 0.00 | 0.40 | 100% | | | |
| 185 | M | 720035.84 | 741266.42 | 6.00 | 279.00 | 0.00 | 0.00 | 0.40 | 100% | | | |
| 186 | M | 720056.91 | 741270.96 | 6.00 | 279.00 | 0.00 | 0.00 | 0.40 | 100% | | | |
| 187 | M | 720071.72 | 741273.88 | 6.00 | 279.00 | 0.00 | 0.00 | 0.40 | 100% | | | |
| 188 | M | 719858.85 | 741256.14 | 6.00 | 263.00 | 0.00 | 0.00 | 0.40 | 100% | | | |
| 189 | M | 719876.15 | 741252.91 | 6.00 | 261.00 | 0.00 | 0.00 | 0.40 | 100% | | | |
| 190 | M | 719898.96 | 741248.81 | 6.00 | 261.00 | 0.00 | 0.00 | 0.40 | 100% | | | |
| 191 | M | 719916.31 | 741245.48 | 6.00 | 258.00 | 0.00 | 0.00 | 0.40 | 100% | | | |
| 192 | E | 719925.29 | 741212.89 | 5.00 | 261.00 | 0.00 | 0.00 | 0.40 | 100% | | | |
| 193 | E | 719897.02 | 741217.65 | 5.00 | 257.00 | 0.00 | 0.00 | 0.40 | 100% | | | |
| 194 | E | 719866.96 | 741223.37 | 5.00 | 260.00 | 0.00 | 0.00 | 0.40 | 100% | | | |
| 195 | E | 719838.48 | 741228.31 | 5.00 | 262.00 | 0.00 | 0.00 | 0.40 | 100% | | | |
| 196 | E | 720237.67 | 741282.05 | 5.00 | 125.00 | 0.00 | 0.00 | 0.40 | 100% | | | |
| 197 | E | 720235.59 | 741297.48 | 5.00 | 269.00 | 0.00 | 0.00 | 0.40 | 100% | | | |
| 198 | E | 720265.07 | 741299.15 | 5.00 | 272.00 | 0.00 | 0.00 | 0.40 | 100% | | | |
| 199 | L | 720294.25 | 741297.17 | 5.00 | 181.00 | 0.00 | 0.00 | 0.40 | 100% | | | |
| 200 | L | 720280.99 | 741312.39 | 5.00 | 0.00 | 0.00 | 0.00 | 0.40 | 100% | | | |
| 201 | L | 720279.27 | 741340.16 | 5.00 | 0.00 | 0.00 | 0.00 | 0.40 | 100% | | | |
| 202 | L | 720290.52 | 741359.07 | 5.00 | 181.00 | 0.00 | 0.00 | 0.40 | 100% | | | |
| 203 | L | 720292.29 | 741327.37 | 5.00 | 181.00 | 0.00 | 0.00 | 0.40 | 100% | | | |
| 204 | J | 720257.46 | 741368.67 | 6.00 | 272.00 | 0.00 | 0.00 | 0.40 | 100% | | | |
| 205 | J | 720235.78 | 741353.12 | 6.00 | 90.00 | 0.00 | 0.00 | 0.40 | 100% | | | |
| 205 | J | 720381.63 | 741384.77 | 6.00 | 95.00 | 0.00 | 0.00 | 0.40 | 100% | | | |
| 207 | H | 720279.61 | 741384.14 | 5.00 | 1.00 | 0.00 | 0.00 | 0.40 | 100% | | | |
| 208 | H | 720278.73 | 741401.08 | 5.00 | 1.00 | 0.00 | 0.00 | 0.40 | 100% | | | |
| 209 | J | 720292.11 | 741370.11 | 6.00 | 156.00 | 0.00 | 0.00 | 0.40 | 100% | | | |
| 210 | H | 720303.68 | 741399.19 | 5.00 | 181.00 | 0.00 | 0.00 | 0.40 | 100% | | | |
| 211 | J | 720318.03 | 741379.34 | 6.00 | 98.00 | 0.00 | 0.00 | 0.40 | 100% | | | |
| 212 | J | 720348.65 | 741382.02 | 6.00 | 101.00 | 0.00 | 0.00 | 0.40 | 100% | | | |
| 212 | J | 720270.42 | 741355.63 | 6.00 | 98.00 | 0.00 | 0.00 | 0.40 | 100% | | | |
| 214 | M | 720408.61 | 741397.67 | 6.00 | 161.00 | 0.00 | 0.00 | 0.40 | 100% | | | |
| 215 | M | 720408.67 | 741397.67 | 6.00 | 336.00 | 0.00 | 0.00 | 0.40 | 100% | | | |
| 216 | E | 720432.51 | 741404.78 | 5.00 | 129.00 | 0.00 | 0.00 | 0.40 | 100% | | | |
| 217 | H | 720390.16 | 741406.47 | 5.00 | 4.00 | 0.00 | 0.00 | 0.40 | 100% | | | |

Layout Continued

| ID | Type | X | Y | Height | Angle | Tilt | Cant | Out-reach | Dimmed to | Target X | Target Y | Target Z |
|-----|------|-----------|-----------|--------|--------|------|------|-----------|-----------|----------|----------|----------|
| 218 | L | 720362.96 | 741397.19 | 6.00 | 278.00 | 0.00 | 0.00 | 0.40 | 100% | | | |
| 219 | H | 720416.67 | 741413.53 | 5.00 | 185.00 | 0.00 | 0.00 | 0.40 | 100% | | | |
| 220 | O | 719755.12 | 741185.32 | 5.00 | 335.00 | 0.00 | 0.00 | 0.45 | 80% | | | |
| 221 | O | 719778.57 | 741182.32 | 5.00 | 264.00 | 0.00 | 0.00 | 0.45 | 80% | | | |
| 222 | A | 719778.52 | 741216.71 | 5.00 | 311.00 | 0.00 | 0.00 | 0.45 | 80% | | | |
| 223 | A | 719804.10 | 741240.58 | 5.00 | 311.00 | 0.00 | 0.00 | 0.45 | 80% | | | |
| 224 | A | 719829.40 | 741264.44 | 5.00 | 311.00 | 0.00 | 0.00 | 0.45 | 80% | | | |
| 225 | A | 719850.05 | 741283.49 | 5.00 | 317.00 | 0.00 | 0.00 | 0.45 | 80% | | | |
| 226 | A | 719872.03 | 741304.34 | 5.00 | 311.00 | 0.00 | 0.00 | 0.45 | 80% | | | |
| 227 | A | 719887.06 | 741318.63 | 5.00 | 337.00 | 0.00 | 0.00 | 0.45 | 80% | | | |
| 228 | A | 719879.83 | 741325.92 | 5.00 | 77.00 | 0.00 | 0.00 | 0.45 | 80% | | | |
| 229 | A | 719859.72 | 741351.46 | 5.00 | 349.00 | 0.00 | 0.00 | 0.45 | 80% | | | |
| 230 | A | 719871.92 | 741383.73 | 5.00 | 340.00 | 0.00 | 0.00 | 0.45 | 80% | | | |
| 231 | A | 719881.86 | 741409.49 | 5.00 | 336.00 | 0.00 | 0.00 | 0.45 | 80% | | | |
| 232 | A | 719894.75 | 741440.33 | 5.00 | 328.00 | 0.00 | 0.00 | 0.45 | 80% | | | |
| 233 | A | 719918.13 | 741467.42 | 5.00 | 321.00 | 0.00 | 0.00 | 0.45 | 80% | | | |
| 234 | A | 719935.54 | 741495.20 | 5.00 | 344.00 | 0.00 | 0.00 | 0.45 | 80% | | | |
| 235 | A | 719960.51 | 741511.89 | 5.00 | 278.00 | 0.00 | 0.00 | 0.45 | 80% | | | |
| 236 | A | 719856.64 | 741270.90 | 5.00 | 54.00 | 0.00 | 0.00 | 0.45 | 80% | | | |
| 236 | R | 719671.25 | 741747.58 | 6.00 | 81.00 | 0.00 | 0.00 | 0.40 | 100% | | | |
| 237 | R | 719687.81 | 741762.09 | 6.00 | 81.00 | 0.00 | 0.00 | 0.40 | 100% | | | |
| 238 | R | 719712.71 | 741759.26 | 6.00 | 81.00 | 0.00 | 0.00 | 0.40 | 100% | | | |
| 239 | R | 719663.61 | 741773.51 | 6.00 | 352.00 | 0.00 | 0.00 | 0.40 | 100% | | | |
| 240 | R | 719689.92 | 741779.81 | 6.00 | 269.00 | 0.00 | 0.00 | 0.40 | 100% | | | |
| 241 | R | 719714.85 | 741776.70 | 6.00 | 260.00 | 0.00 | 0.00 | 0.40 | 100% | | | |
| 242 | Q | 720049.44 | 741500.77 | 6.00 | 145.00 | 0.00 | 0.00 | 0.40 | 100% | | | |
| 243 | O | 720165.89 | 741484.27 | 5.00 | 212.00 | 0.00 | 0.00 | 0.40 | 80% | | | |
| 244 | R | 720255.61 | 741461.37 | 6.00 | 349.00 | 0.00 | 0.00 | 0.40 | 100% | | | |
| 245 | R | 720425.52 | 741464.12 | 6.00 | 343.00 | 0.00 | 0.00 | 0.40 | 100% | | | |
| 246 | O | 720444.92 | 741459.81 | 5.00 | 9.00 | 0.00 | 0.00 | 0.40 | 80% | | | |
| 247 | K | 720472.27 | 741451.73 | 6.00 | 343.00 | 0.00 | 0.00 | 0.40 | 100% | | | |
| 248 | K | 720527.28 | 741420.48 | 6.00 | 335.00 | 0.00 | 0.00 | 0.40 | 100% | | | |
| 249 | Q | 720540.83 | 741413.41 | 6.00 | 168.00 | 0.00 | 0.00 | 0.40 | 100% | | | |
| 250 | K | 720568.17 | 741401.72 | 6.00 | 180.00 | 0.00 | 0.00 | 0.40 | 100% | | | |
| 251 | Q | 720766.84 | 741362.61 | 6.00 | 2.00 | 0.00 | 0.00 | 0.40 | 100% | | | |
| 252 | O | 720780.28 | 741369.46 | 5.00 | 198.00 | 0.00 | 0.00 | 0.40 | 80% | | | |

Layout Continued

| ID | Type | X | Y | Height | Angle | Tilt | Cant | Out-reach | Dimmed to | Target X | Target Y | Target Z |
|-----|------|-----------|-----------|--------|--------|------|------|-----------|-----------|----------|----------|----------|
| 253 | E | 720452.51 | 741410.65 | 5.00 | 263.00 | 0.00 | 0.00 | 0.40 | 100% | | | |
| 254 | A | 719822.60 | 741237.95 | 5.00 | 31.00 | 0.00 | 0.00 | 0.45 | 80% | | | |
| 255 | A | 719929.91 | 741196.94 | 5.00 | 125.00 | 0.00 | 0.00 | 0.45 | 80% | | | |
| 256 | A | 719920.30 | 741182.88 | 5.00 | 76.00 | 0.00 | 0.00 | 0.45 | 80% | | | |
| 257 | A | 719958.15 | 741175.98 | 5.00 | 197.00 | 0.00 | 0.00 | 0.45 | 80% | | | |
| 258 | A | 719946.07 | 741179.68 | 5.00 | 91.00 | 0.00 | 0.00 | 0.45 | 80% | | | |
| 259 | Q | 720577.14 | 741343.31 | 6.00 | 0.00 | 0.00 | 0.00 | 0.40 | 100% | | | |
| 260 | Q | 720594.62 | 741346.82 | 6.00 | 182.00 | 0.00 | 0.00 | 0.40 | 100% | | | |
| 261 | K | 720608.25 | 741344.13 | 5.00 | 11.00 | 0.00 | 0.00 | 0.40 | 100% | | | |
| 262 | Q | 720615.53 | 741332.70 | 6.00 | 268.00 | 0.00 | 0.00 | 0.40 | 100% | | | |
| 263 | K | 720666.20 | 741336.65 | 5.00 | 169.00 | 0.00 | 0.00 | 0.40 | 100% | | | |
| 264 | Q | 720638.31 | 741322.20 | 6.00 | 94.00 | 0.00 | 0.00 | 0.40 | 100% | | | |
| 265 | Q | 720669.25 | 741327.36 | 6.00 | 255.00 | 0.00 | 0.00 | 0.40 | 100% | | | |
| 266 | Q | 720695.93 | 741313.51 | 6.00 | 98.00 | 0.00 | 0.00 | 0.40 | 100% | | | |
| 267 | Q | 720701.28 | 741331.80 | 6.00 | 326.00 | 0.00 | 0.00 | 0.40 | 100% | | | |
| 268 | Q | 720717.61 | 741326.16 | 6.00 | 164.00 | 0.00 | 0.00 | 0.40 | 100% | | | |
| 269 | K | 720689.82 | 741325.64 | 6.00 | 253.00 | 0.00 | 0.00 | 0.40 | 100% | | | |
| 270 | Q | 720727.80 | 741307.63 | 6.00 | 280.00 | 0.00 | 0.00 | 0.40 | 100% | | | |
| 271 | K | 720775.74 | 741324.50 | 5.00 | 310.00 | 0.00 | 0.00 | 0.40 | 100% | | | |
| 272 | K | 720774.67 | 741304.27 | 5.00 | 41.00 | 0.00 | 0.00 | 0.40 | 100% | | | |
| 273 | Q | 720053.89 | 741541.38 | 6.00 | 264.00 | 0.00 | 0.00 | 0.40 | 100% | | | |
| 274 | O | 720008.36 | 741534.63 | 5.00 | 77.00 | 0.00 | 0.00 | 0.40 | 80% | | | |
| 275 | O | 720037.79 | 741531.32 | 5.00 | 72.00 | 0.00 | 0.00 | 0.40 | 80% | | | |
| 276 | Q | 720061.70 | 741525.03 | 6.00 | 145.00 | 0.00 | 0.00 | 0.40 | 100% | | | |
| 277 | P | 719998.55 | 741569.73 | 6.00 | 184.00 | 0.00 | 0.00 | 0.40 | 100% | | | |
| 278 | O | 720144.87 | 741501.80 | 5.00 | 277.00 | 0.00 | 0.00 | 0.40 | 80% | | | |
| 279 | O | 720168.35 | 741498.18 | 5.00 | 253.00 | 0.00 | 0.00 | 0.40 | 80% | | | |
| 280 | O | 720155.22 | 741501.01 | 5.00 | 22.00 | 0.00 | 0.00 | 0.40 | 80% | | | |
| 281 | L | 720330.45 | 741393.23 | 6.00 | 278.00 | 0.00 | 0.00 | 0.40 | 100% | | | |

Horizontal Illuminance (lux)

Grid 1

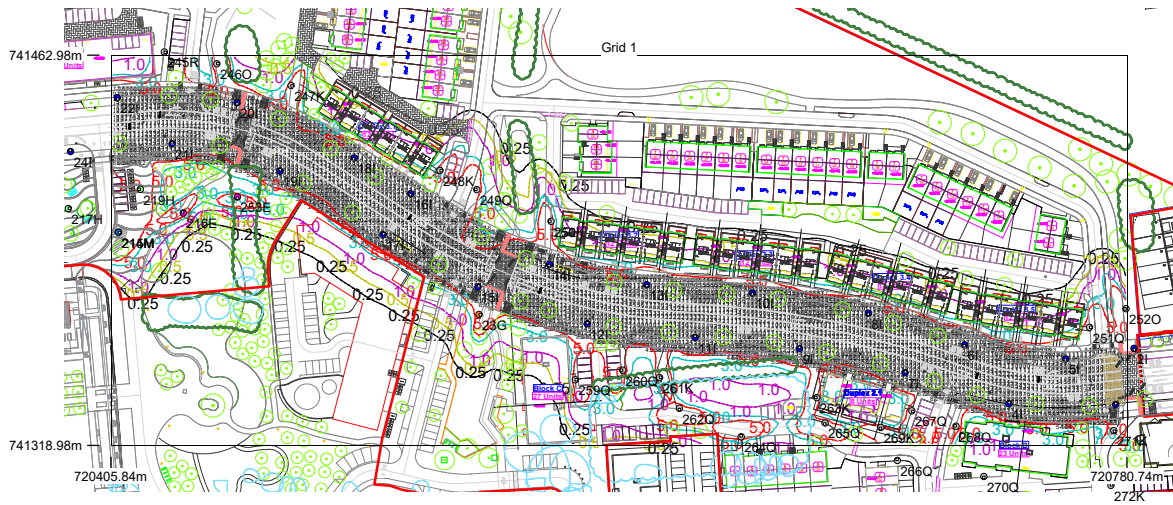

Results

| | |
|-----------|-------|
| Eav | 11.10 |
| Emin | 2.52 |
| Emax | 20.93 |
| Emin/Emax | 0.12 |
| Emin/Eav | 0.23 |
| | |

Horizontal Illuminance (lux)

Grid 2

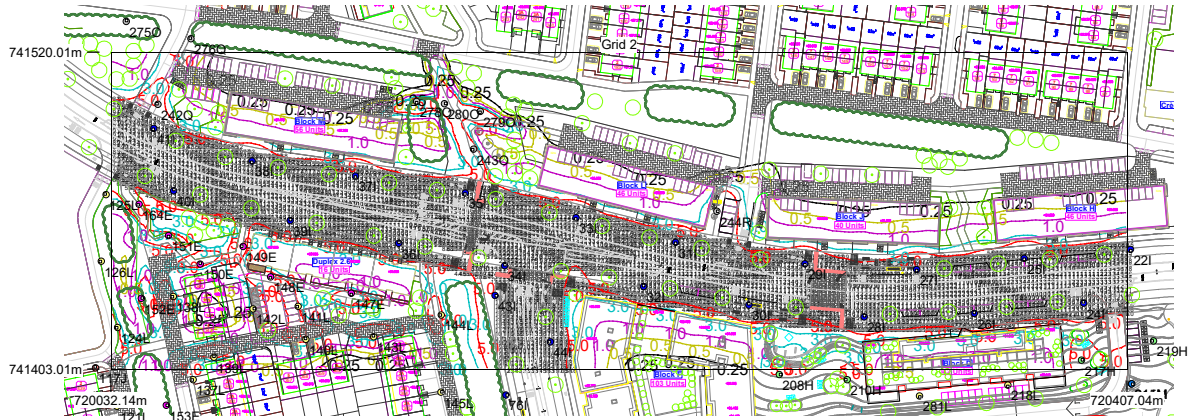

Results

| | |
|-----------|-------|
| Eav | 10.51 |
| Emin | 3.68 |
| Emax | 25.24 |
| Emin/Emax | 0.15 |
| Emin/Eav | 0.35 |
| | |

Horizontal Illuminance (lux)

Grid 3

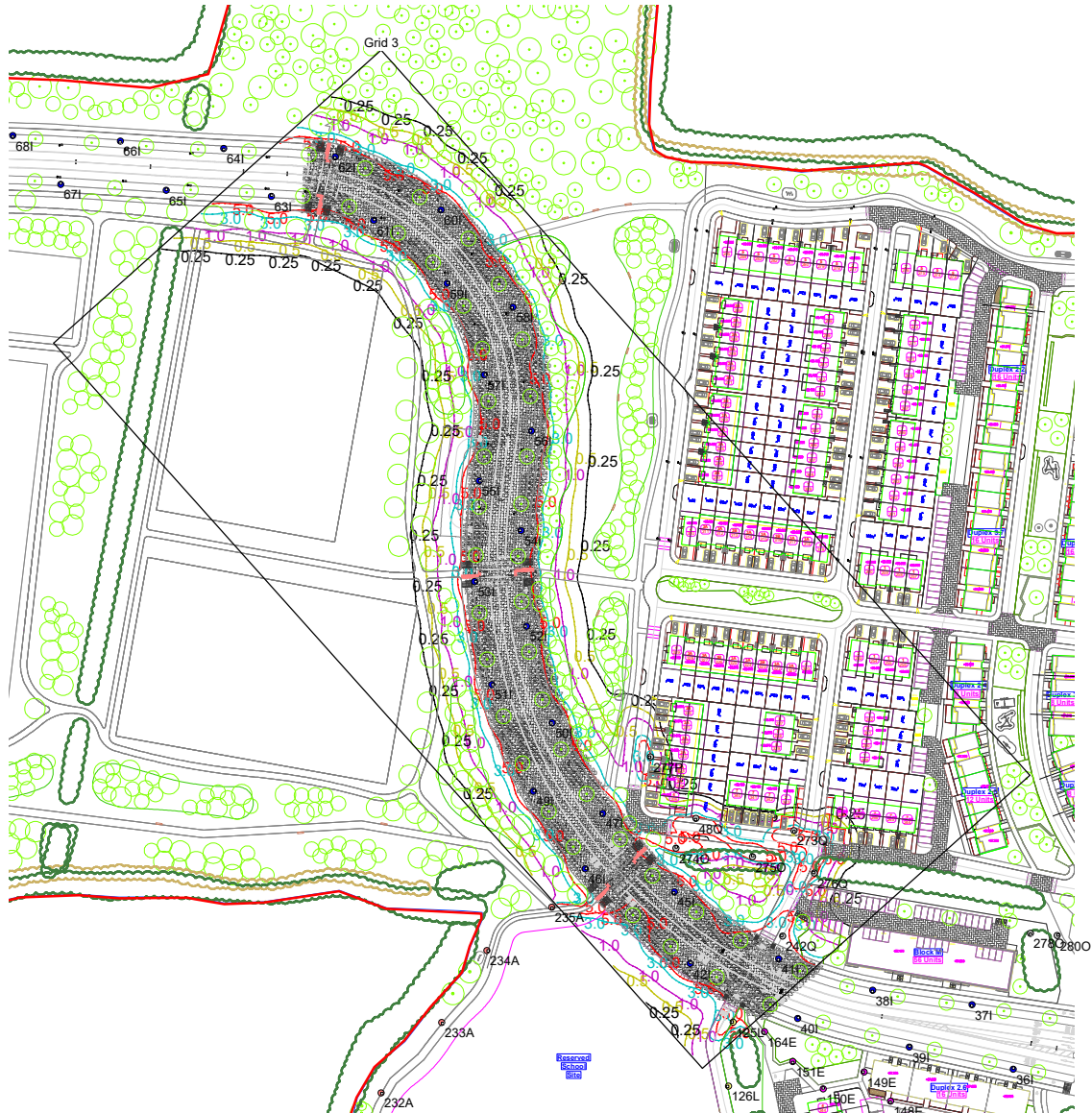

Results

| | |
|-----------|-------|
| Eav | 10.39 |
| Emin | 2.82 |
| Emax | 19.89 |
| Emin/Emax | 0.14 |
| Emin/Eav | 0.27 |

Horizontal Illuminance (lux)

Grid 4

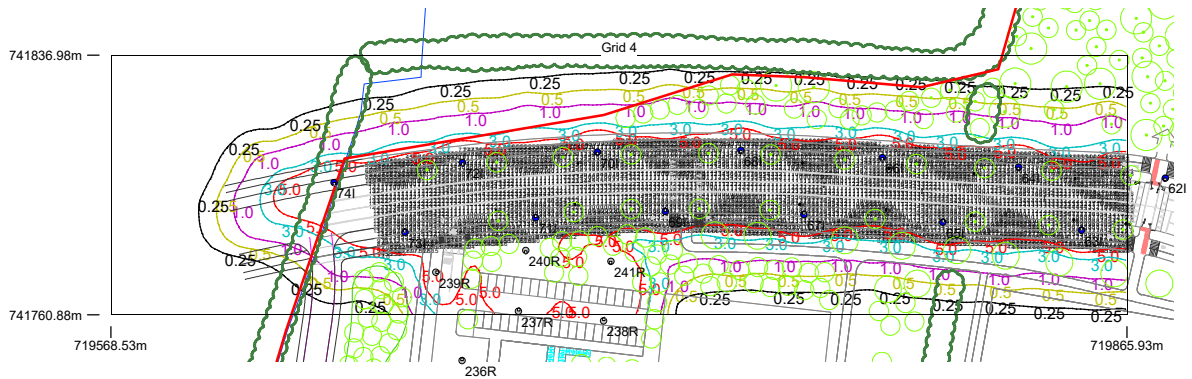

Results

| | |
|-----------|-------|
| Eav | 10.91 |
| Emin | 3.48 |
| Emax | 19.43 |
| Emin/Emax | 0.18 |
| Emin/Eav | 0.32 |
| | |

Horizontal Illuminance (lux)

Grid 5



Results

| | |
|-----------|-------|
| Eav | 10.36 |
| Emin | 4.94 |
| Emax | 24.96 |
| Emin/Emax | 0.20 |
| Emin/Eav | 0.48 |
| | |

Horizontal Illuminance (lux)

Grid 6

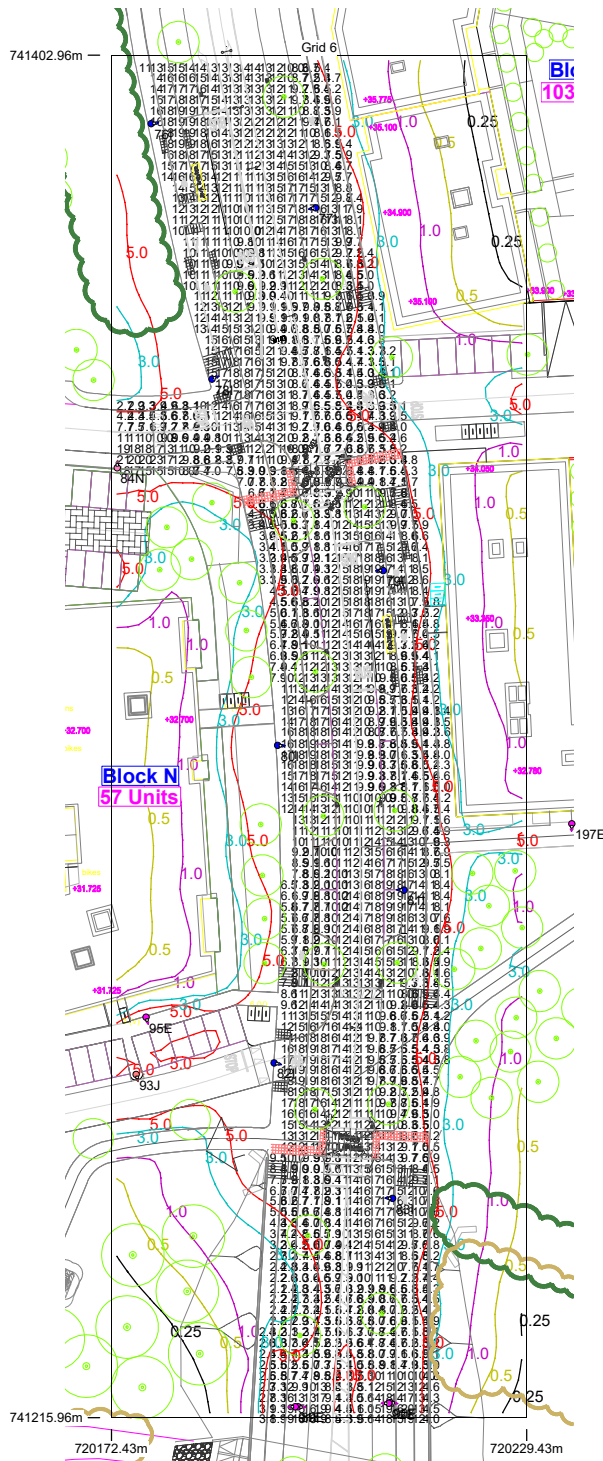

Results

| | |
|-----------|-------|
| Eav | 10.39 |
| Emin | 2.14 |
| Emax | 22.66 |
| Emin/Emax | 0.09 |
| Emin/Eav | 0.21 |

Horizontal Illuminance (lux)

Grid 7



Results

| | |
|-----------|-------|
| Eav | 5.53 |
| Emin | 1.06 |
| Emax | 18.65 |
| Emin/Emax | 0.06 |
| Emin/Eav | 0.19 |
| | |

Horizontal Illuminance (lux)

Grid 8

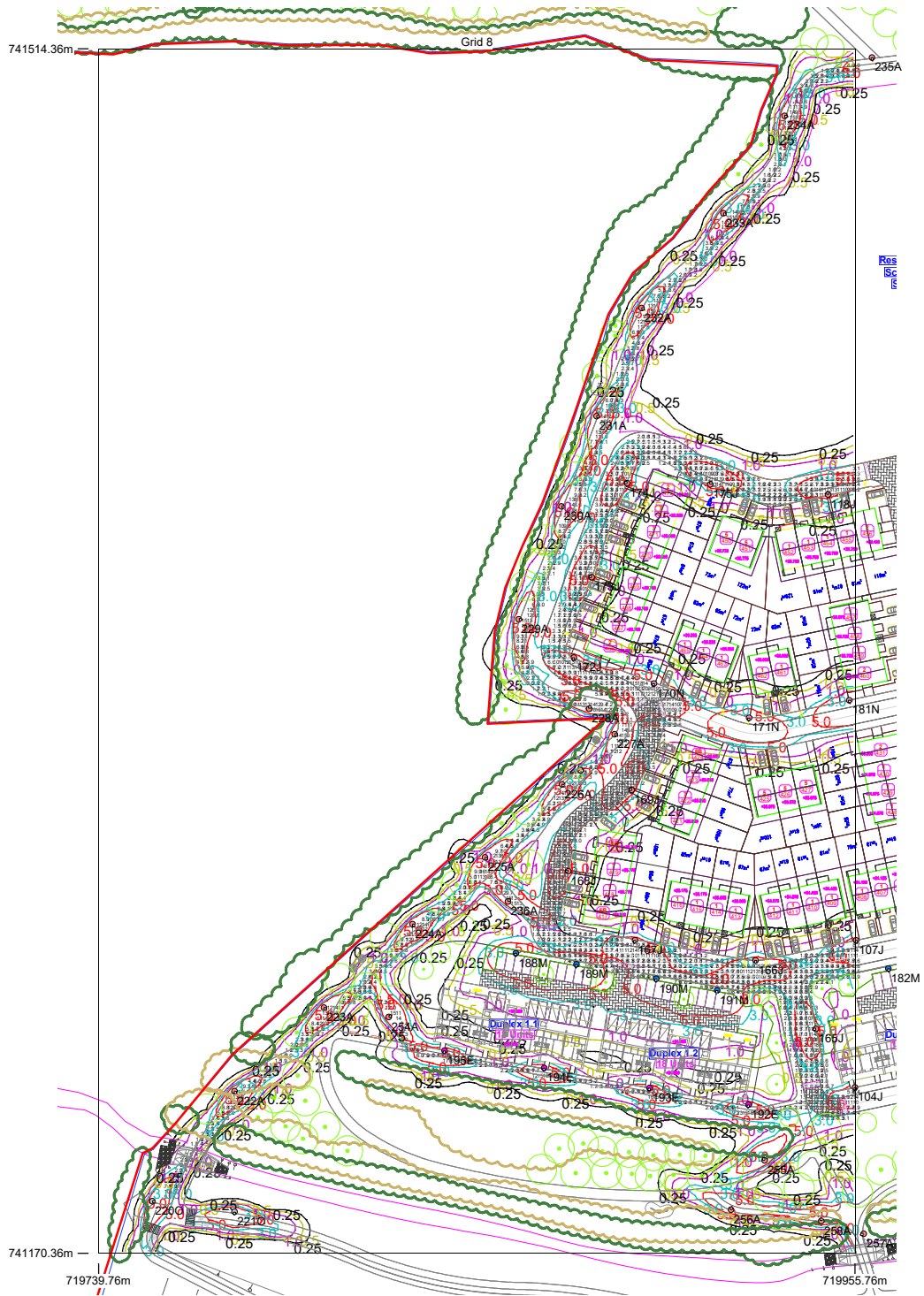

Results

| | |
|-----------|-------|
| Eav | 5.89 |
| Emin | 1.16 |
| Emax | 22.75 |
| Emin/Emax | 0.05 |
| Emin/Eav | 0.20 |

Horizontal Illuminance (lux)

Grid 9

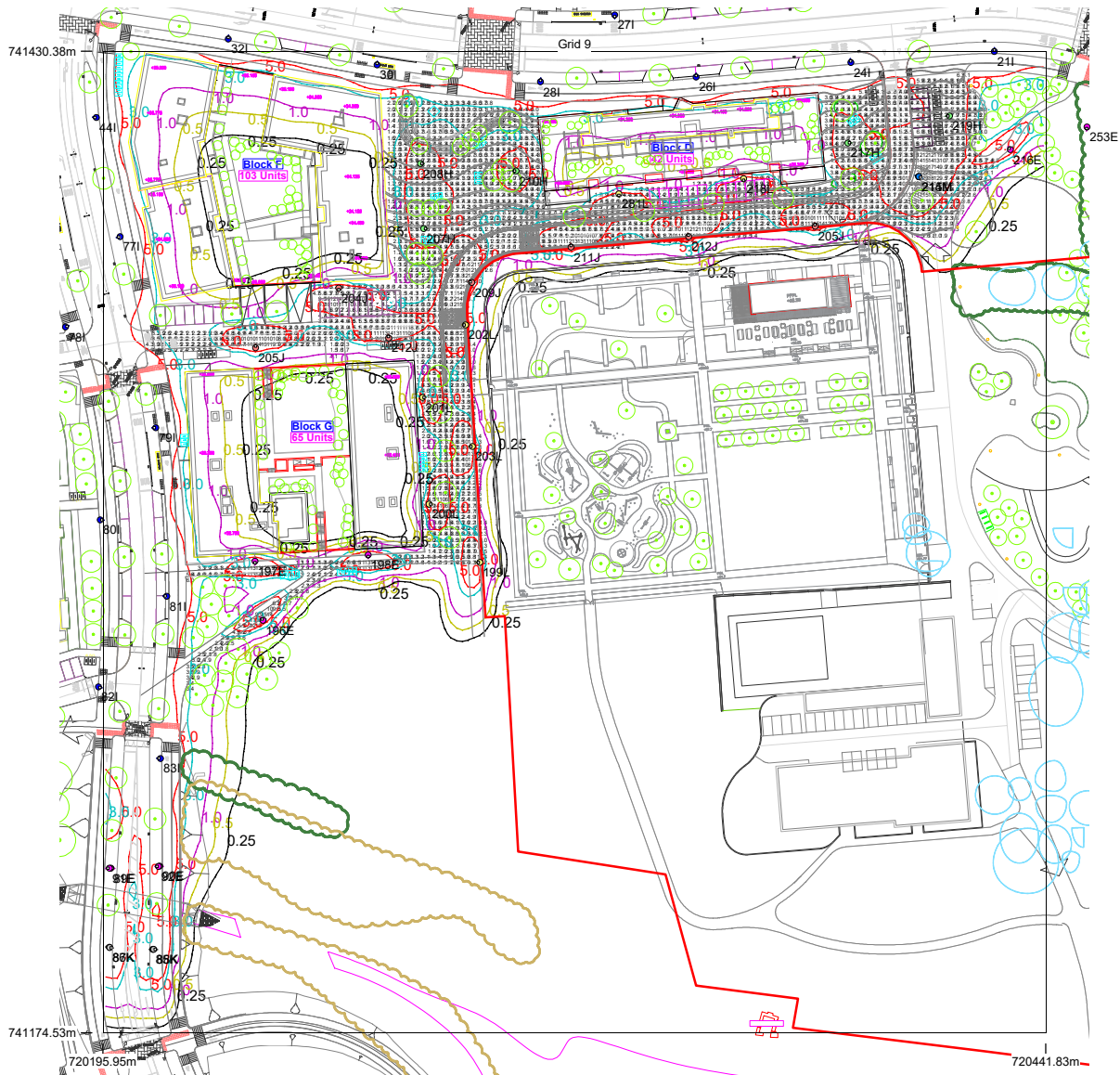

Results

| | |
|-----------|-------|
| Eav | 5.00 |
| Emin | 1.01 |
| Emax | 23.50 |
| Emin/Emax | 0.04 |
| Emin/Eav | 0.20 |
| | |

Horizontal Illuminance (lux)

Grid 15

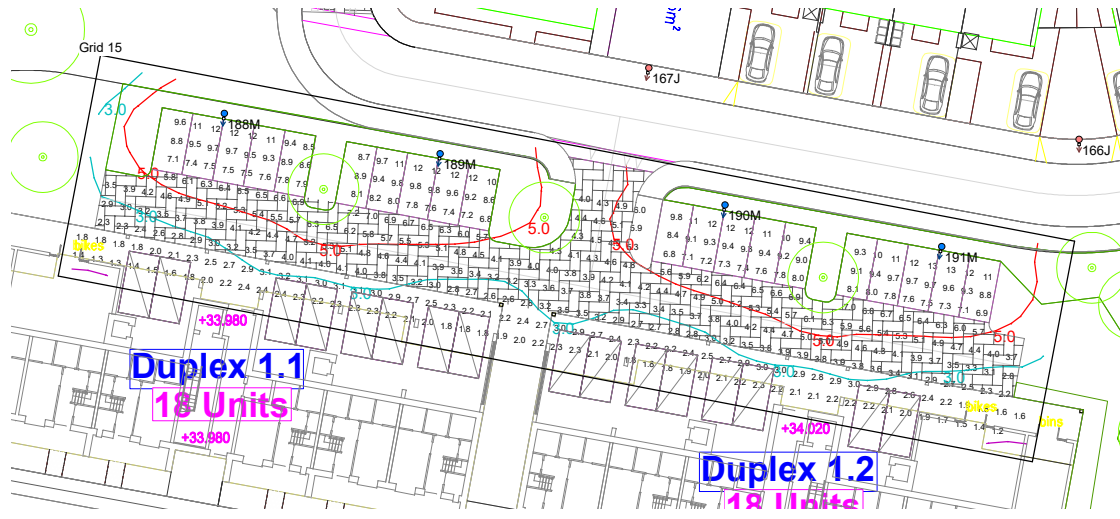

Results

| | |
|-----------|-------|
| Eav | 5.06 |
| Emin | 1.24 |
| Emax | 12.74 |
| Emin/Emax | 0.10 |
| Emin/Eav | 0.25 |
| | |