

- NOTES:
- DO NOT SCALE. USE FIGURED DIMENSIONS ONLY.
 - THIS DRAWING IS TO BE READ IN CONJUNCTION WITH ALL OTHER RELEVANT ARCHITECTURAL AND ENGINEERING DRAWINGS.

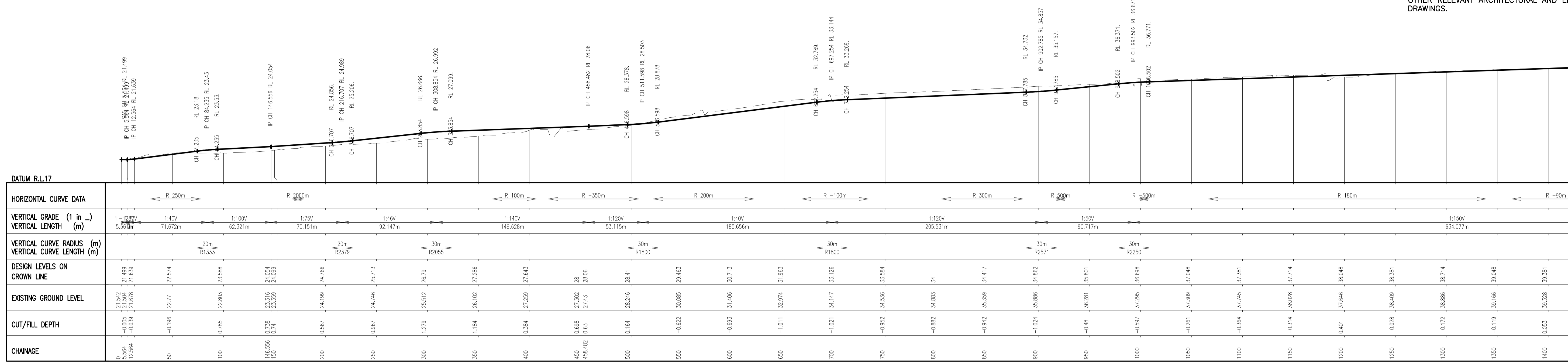

CROWN LINE SECTION ON EAST WEST LINK ROAD

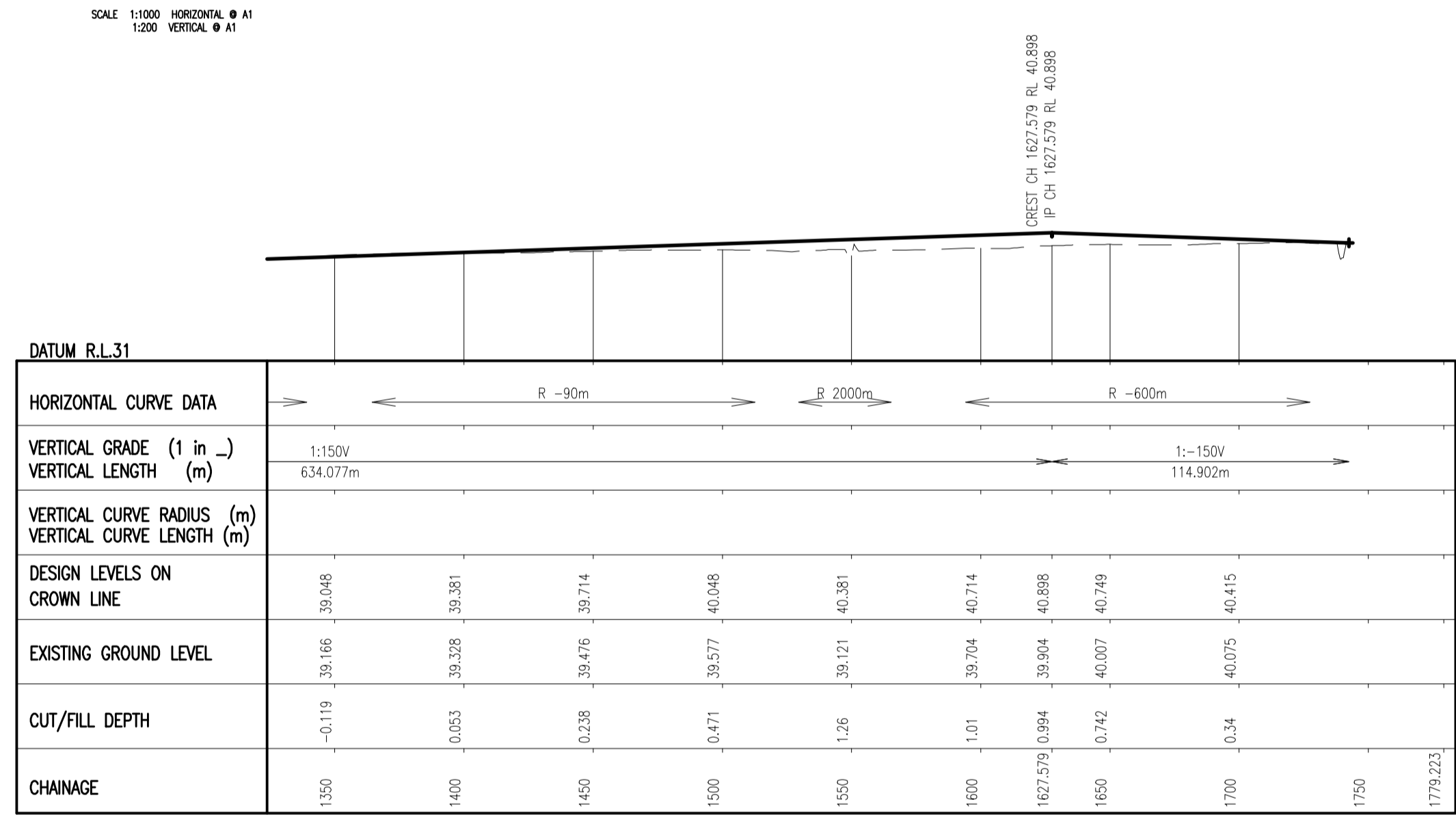

CROWN LINE SECTION ON EAST WEST LINK ROAD

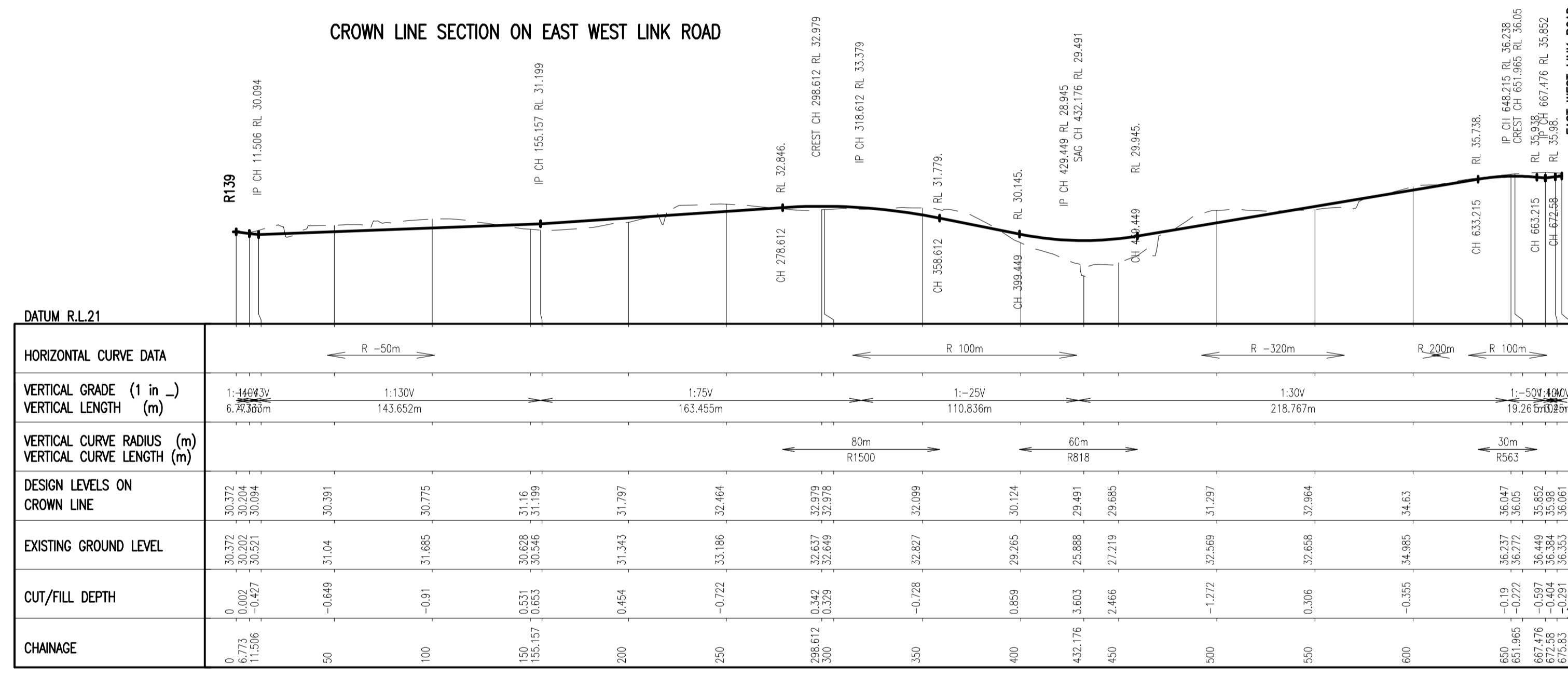

CROWN LINE SECTION ON PARKWAY BOULEVARD

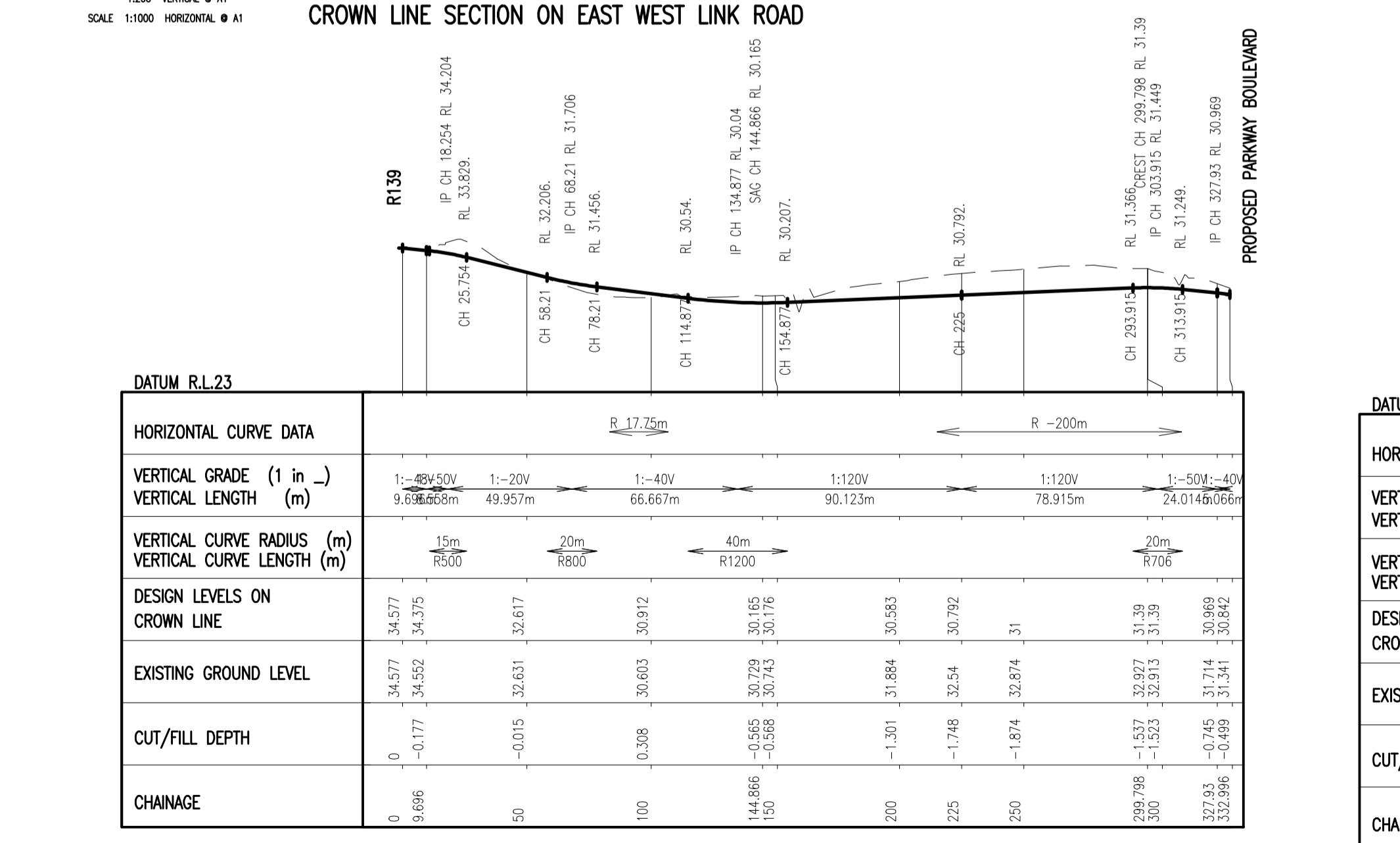

CROWN LINE SECTION ON R139 LINK ROAD

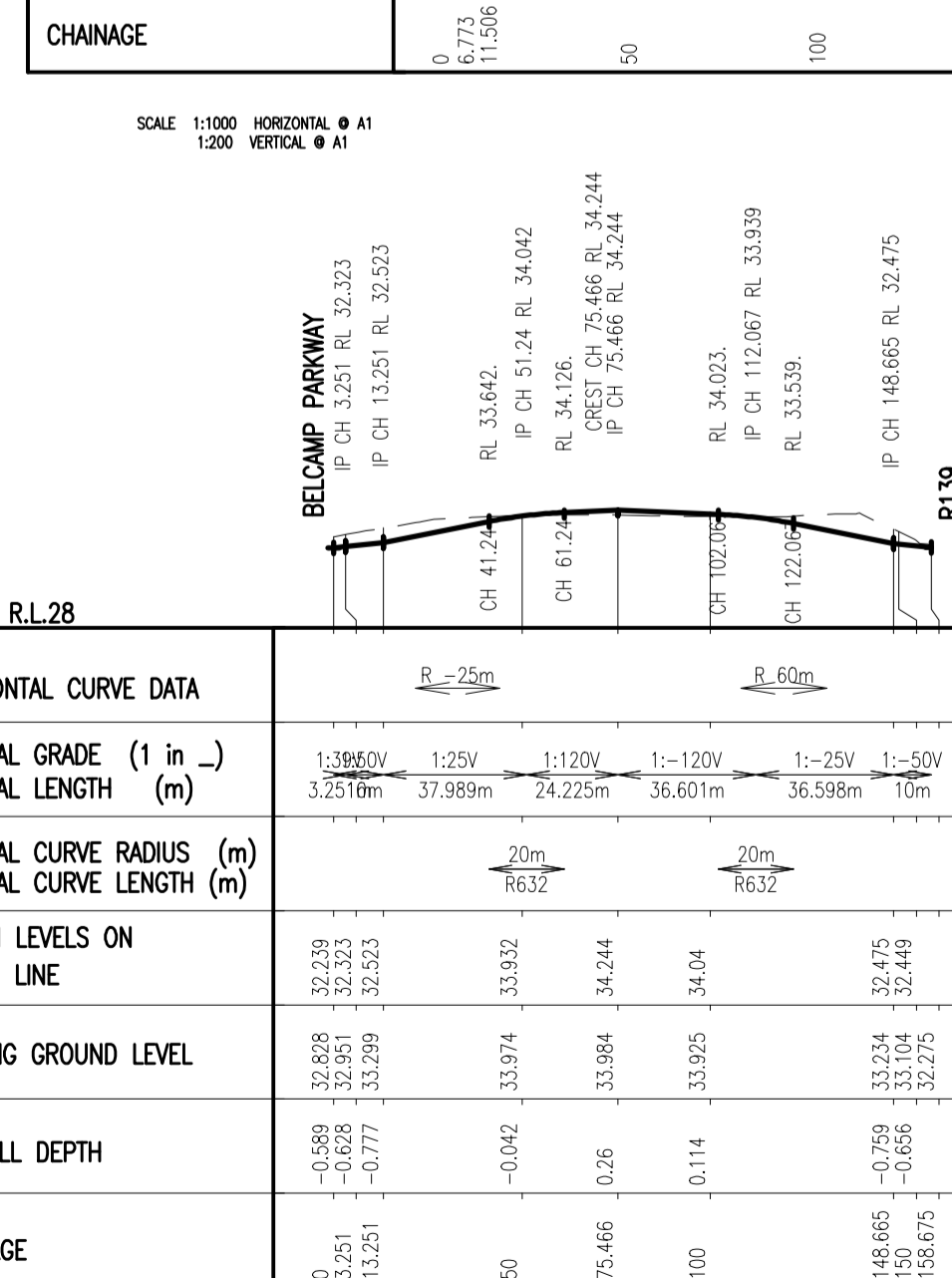

CROWN LINE SECTION ON BUS GATE

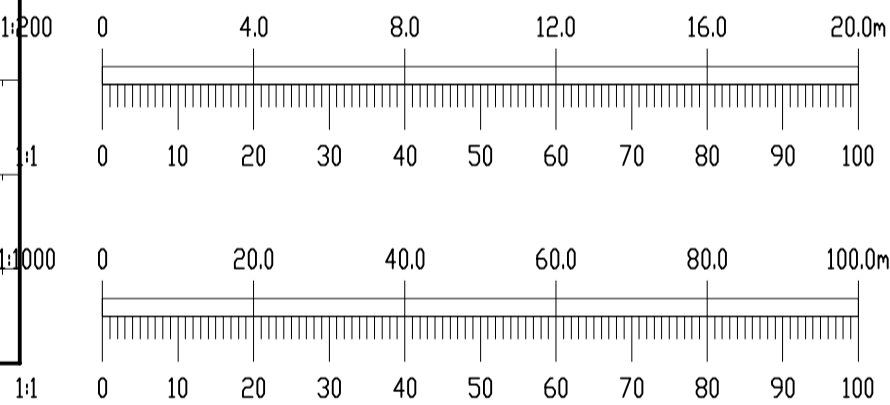

REV.	DATE	AMENDMENT	DRN	APPD

STATUS: **FOR PLANNING NOT FOR CONSTRUCTION**

Waterman Moylan
Engineering Consultants
BLOCK 5, EASTPOINT BUSINESS PARK, ALFIE BYRNE ROAD,
DUBLIN D03 H3F4 IRELAND. Tel: (01) 664 8900
Email: info@waterman-moylan.ie www.waterman-moylan.ie

CLIENT: GERARD GANNON PROPERTIES
ARCHITECT: CONROY CROWE KELLY / WILSON ARCHITECTURE

PROJECT: **PROPOSED STRATEGIC HOUSING DEVELOPMENT AT BELCAMP, DUBLIN 17**

TITLE: **ROAD LONG SECTIONS**

DRAWN	DESIGNED	APPROVED	DATE
NS	DA	MD	APRIL 2022
SCALE AS SHOWN @ A1	JOB NO. 19-114	DRG. NO. P1130	REVISION

© 2017. This drawing is copyright. No part of this document may be reproduced or transmitted in any form or stored in any retrieval system of any nature without the written permission of the consulting engineer or copyright holder except as agreed for use on the project for which the document was originally issued.